

The Best Products, The Best Service...

SERVICE METAL

ONE CALL GETS IT ALL



Reducing Tee 300# Malleable Iron Inches / Pounds

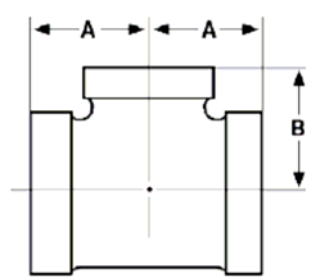

Size	A	B	Approximate Weight (in Pounds)
3/4 x 1/2	1.31	1.38	0.90
1 x 1/2	1.44	1.50	1.26
1 x 3/4	1.50	1.56	1.33
1 1/4 x 1/2	1.50	1.69	1.70
1 1/4 x 3/4	1.63	1.75	1.90
1 1/4 x 1	1.75	1.81	2.10
1 1/2 x 1/2	1.63	1.81	2.27
1 1/2 x 3/4	1.69	1.88	2.46
1 1/2 x 1	1.81	2.00	2.60
1 1/2 x 1 1/4	2.00	2.06	3.05
2 x 1/2	1.75	2.06	3.35
2 x 3/4	1.81	2.13	3.56
2 x 1	2.00	2.25	3.97
2 x 1 1/4	2.13	2.31	4.21
2 x 1 1/2	2.25	2.38	4.60
2 1/2 x 2	2.69	2.75	7.59
3 x 2	2.81	3.13	9.60
4 x 2 1/2	3.70	4.00	15.50
4 x 3	4.00	4.25	16.80

**Malleable Castings conform to ASTM A197*

**Hot-Dipped Galvanized Fittings conform to ASTM A153*

**Malleable Fitting Dimensions conform to ASME B16.3*

**Malleable Bushings, Plugs and Locknuts conform to ASME B16.14*

**Malleable Unions conform to ASME B16.39*

**NPT Threads on all fittings conform to ASME B1.20.1*

**Class 150 fittings are UL listed and FM approved at 300 psi*

**Class 300 fittings are UL listed*